



# 7,500 SF Proposed Retail Center

1985 Campbell Drive | Homestead, FL 33033

**Ivo Tsinev**

Partner

ivo@fusecre.com  
305.934.8390

**Daniel Pou**

Partner

danny@fusecre.com  
305.934.8390

Fuse Commercial LLC

Real Estate Services

10200 SW 66th St, Miami FL

info@fusecre.com | www.fusecre.com



LICENSED REAL ESTATE BROKER

Information herein has been obtained from sources deemed reliable, however accuracy cannot be guaranteed. The user is required to conduct their own due diligence and verification.

# 7,500 SF Proposed Retail Center

1985 Campbell Drive | Homestead, FL 33033



## AVAILABILITIES

- 7,500 SF

## PROPERTY HIGHLIGHTS

- Possibility for an end cap with a drive-thru
- Building can be demised to up to 4 bays.
- High visibility primary east-west road in Homestead with access to the Florida's Turnpike
- Traffic count 32,500 AADT
- A great population within a 5-mile radius of 182,092 people
- Growing density with more than 18 residential developments within a 5-mile radius
- Located near national tenants including Lowes, Walmart, Target, Publix and more

## DEMOGRAPHICS

	1 mile	3 mile	5 mile
Total Population:	20,329	131,383	182,092
Average HH Income:	\$61,402	\$75,192	\$72,709
Households:	6,241	40,159	54,876



Information herein has been obtained from sources deemed reliable, however accuracy cannot be guaranteed. The user is required to conduct their own due diligence and verification.



# 7,500 SF Proposed Retail Center

1985 Campbell Drive | Homestead, FL 33033



Information herein has been obtained from sources deemed reliable, however accuracy cannot be guaranteed. The user is required to conduct their own due diligence and verification.



# 7,500 SF Proposed Retail Center

1985 Campbell Drive | Homestead, FL 33033

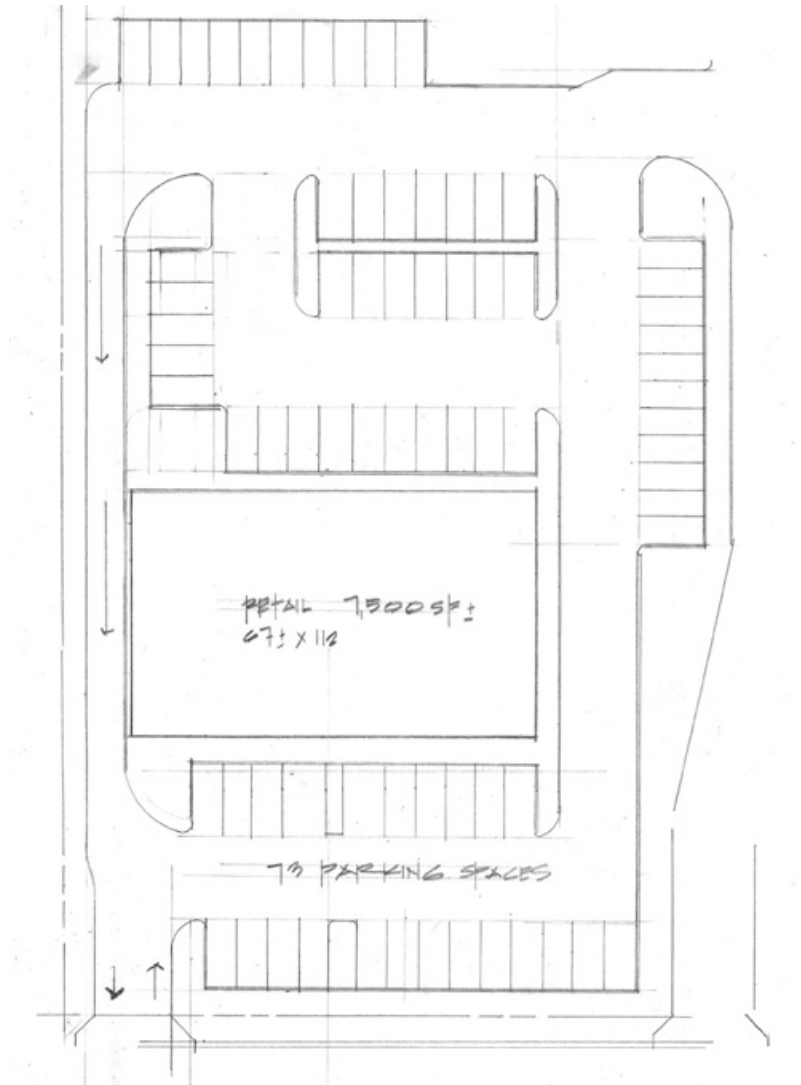

**Ivo Tsinev**

Partner

ivo@fusecre.com  
305.934.8390

**Daniel Pou**

Partner

danny@fusecre.com  
305.934.8390

Fuse Commercial LLC  
Real Estate Services  
10200 SW 66th St, Miami FL  
info@fusecre.com | www.fusecre.com



LICENSED REAL ESTATE BROKER

Information herein has been obtained from sources deemed reliable, however accuracy cannot be guaranteed. The user is required to conduct their own due diligence and verification.